

CARL WOLFS CROSSING RD

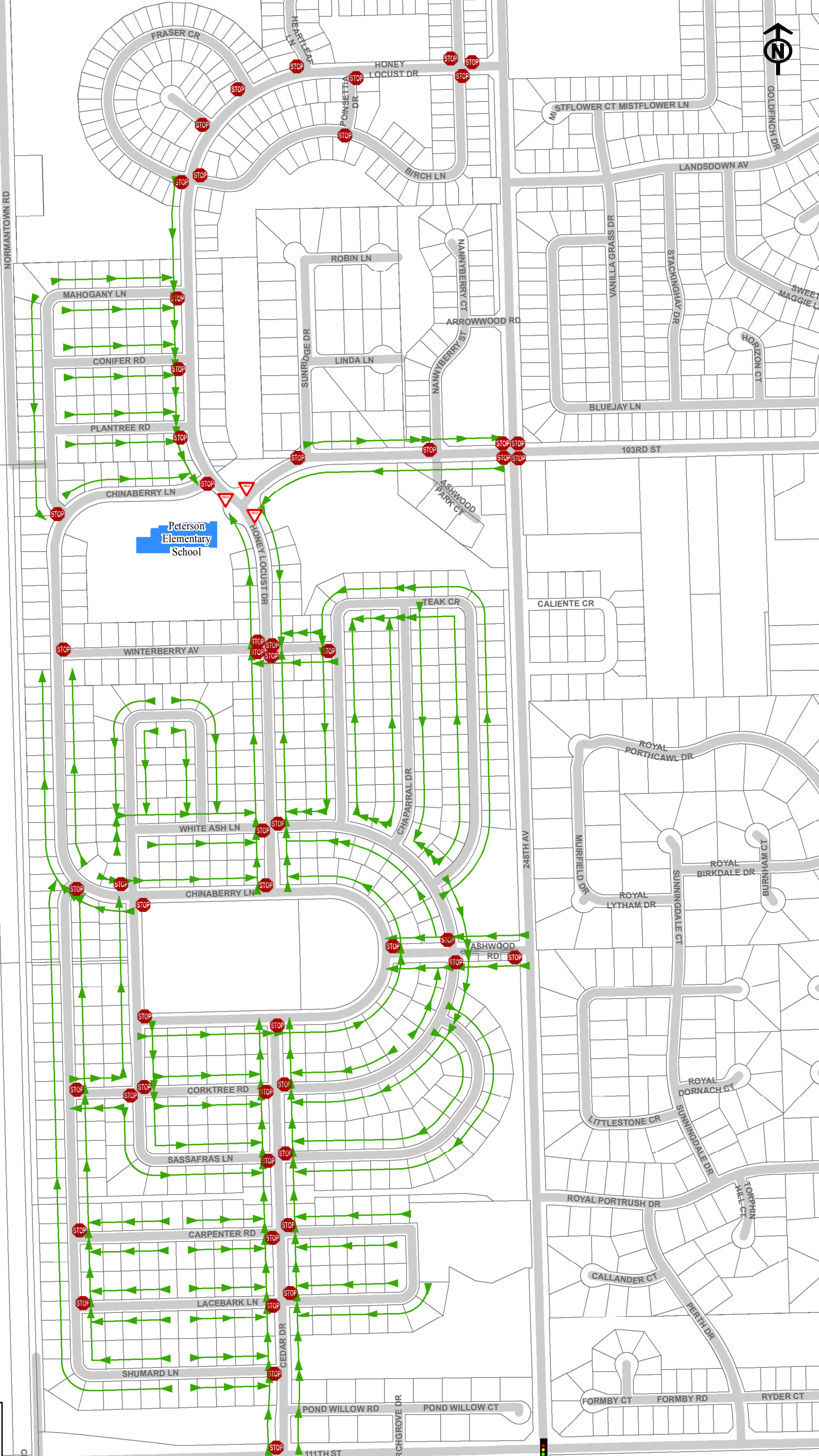

CLOW CREEK RD



City of Naperville
District 204

Peterson Elementary School Walk Route

- School Walk Route
- Crosswalk
- Stop Sign
- Yield Sign

NOTE TO PARENTS:

This map is provided to help you and your child determine the best way to and from school. We suggest you review the map and travel the route with your child, answering any questions and noting walkways, traffic controls, crossing guards, etc.

For questions regarding busing, please contact the appropriate school district administration office.

For questions regarding the school pedestrian walk route or right-of-way controls, please contact the City of Naperville T.E.D. group.

T.E.D. Group
630-420-6100
400 S. Eagle St.
Date: 2/23/2018



Naperville