

PROJECT:

Willoway LLC

419 S. Washington Street
Naperville, IL 60540

CUSTOMER APPROVAL:

DATE

AUTHORIZED SIGNATURE

REPRESENTATIVE

Dan Olson / JB

DRAWN BY

Bill Marlow

DATE

2.07.22

SCALE

1/2" = 1'

SHEET NO.

1 of 2

ESTIMATE / JOB NUMBER

8983

FILE NAME

WIL8983

REVISIONS:

- 1
- 2
- 3
- 4
- 5
- 6
- 7
- 8

This sign is intended to be installed in accordance with the requirements of Article 600 of the National Electrical Code and/or other applicable local codes. This includes proper grounding and bonding of the sign.

Remove & Relocate (1) 5'-8" x 7'-0" Double Face Illuminated Pylon Sign

Sign Cabinets: Existing - Fabricated Aluminum

Faces: Polycarbonate with Vinyl Graphics

Illumination: Retrofit to New White LEDs w/ 12V 60W 120/277V Power Supplies

Power: (1) 20Amp @ 120Volts Electrical Circuit Run to Site by Others

Mounting: (2) New 3" (3½" O.D.) Sch. 40 Steel Pipes Sleeved into (2) New 6" (6.625" O.D.) Std. Steel Pipes

- Pipes Painted MP 41313 Dark Bronze

- Direct Burial into (2) 1'-0" Dia. x 5'-3" Deep Concrete Foundations

NOTE: FIELD SURVEY REQUIRED PRIOR TO FABRICATION

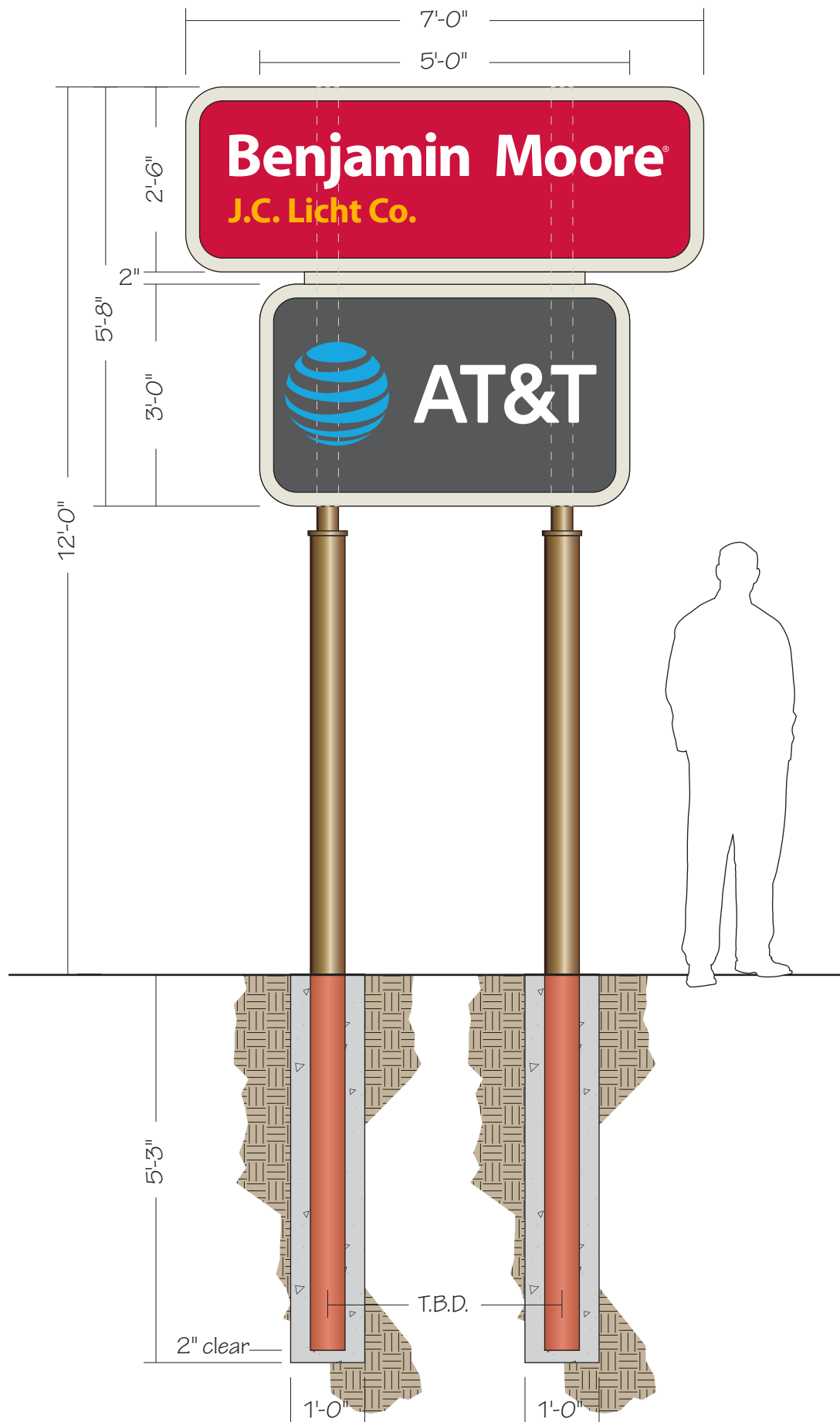

PROJECT:

Willoway LLC

419 S. Washington Street
Naperville, IL 60540

CUSTOMER APPROVAL:

DATE

AUTHORIZED SIGNATURE

REPRESENTATIVE

Dan Olson / JB

DRAWN BY

Bill Marlow

DATE

2.07.22

SCALE

1" = 50'

SHEET NO.

2 of 2

ESTIMATE / JOB NUMBER

8983

FILE NAME

WIL8983

REVISIONS:

1	
2	
3	
4	
5	
6	
7	
8	

This sign is intended to be installed in accordance with the requirements of Article 600 of the National Electrical Code and/or other applicable local codes. This includes proper grounding and bonding of the sign.

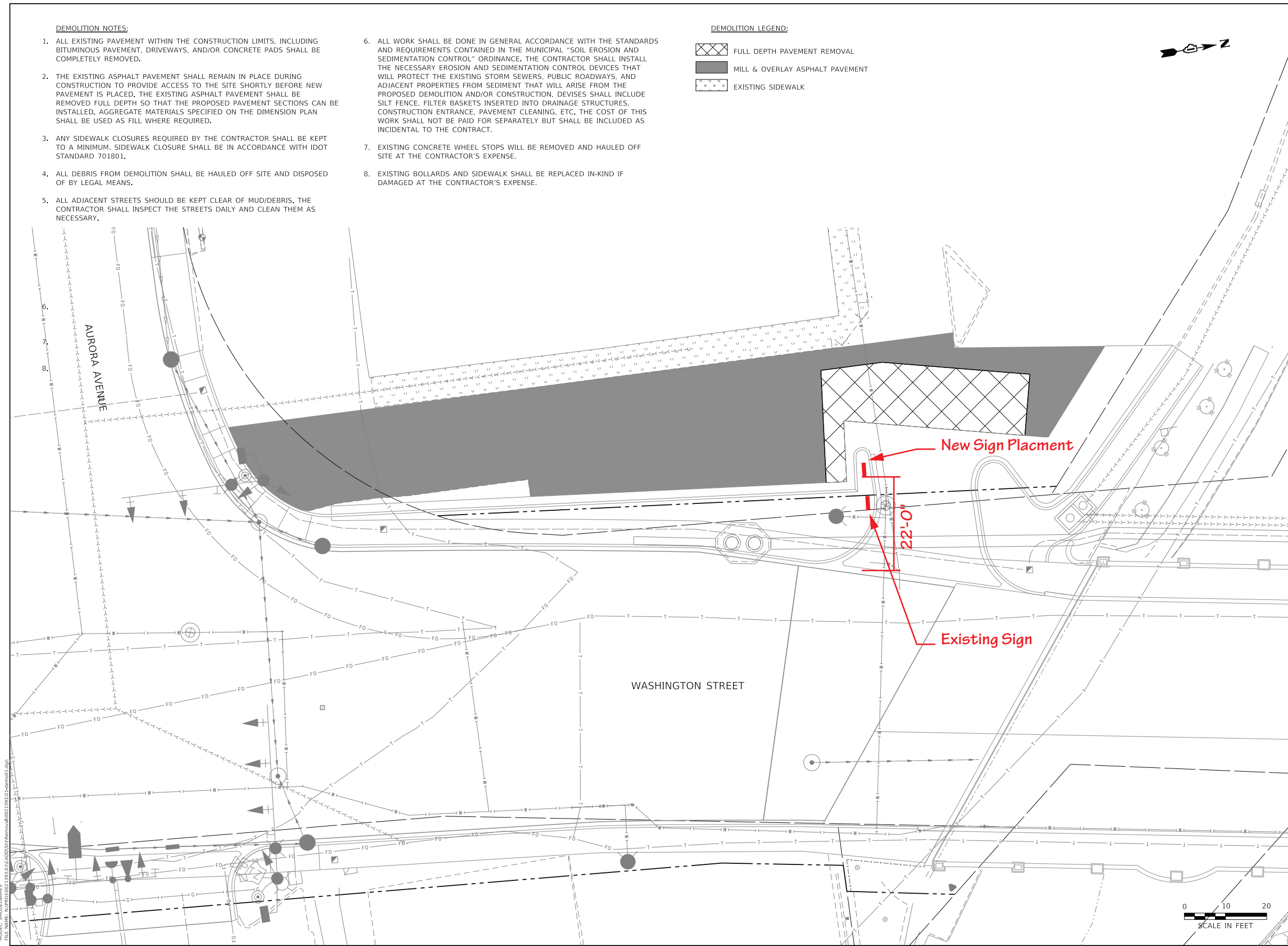

REVISION RECORD

NO.	DATE

CiorbaGroup
8725 W. Higgins Rd, Ste 600, Chicago, IL 60631
P 773.775.4009 | www.ciorba.com

417-423 WASHINGTON STREET
PARKING LOT DESIGN
NAPERVILLE, IL

DESIGNED - TBH
DRAWN - VZ
CHECKED - DLD
DATE - 12/15/2021

SCALE: 1"=10'
PROJ. NO.:

DRAWINGS NO.:
C300
SHEET 4 OF 8



This sign is built to UL Standards for operation in North America.

"This Document is owned by, and the information contained in it is proprietary to, Parvin-Clauss Sign Company. By receipt hereof the holder agrees not to use the information, disclose it to any third party, nor reproduce this document without the prior written consent of Parvin-Clauss Sign Company. Holder also agrees to immediately return this document upon request of Parvin-Clauss Sign Company."

© Copyright 2022 by Parvin-Clauss Sign Co.