

TEMPORARY RIGHT-IN, RIGHT-OUT TO BE CONSTRUCTED WITH PHASE I. THIS DRIVE MAY BE CONVERTED TO FULL ACCESS BY THE CITY OF NAPERVILLE AS PART OF THE FUTURE PLANNED IMPROVEMENTS TO 248TH AVENUE.

EXIST. BIKE PATH

6' HIGH FENCE (TYP)

SCALE: 1" = 40'

SITE DATA TABLE

CURRENT ZONING:	R1
PROPOSED ZONING:	R1 WITH CONDITIONAL USE
LOT AREA:	593,857 S.F. (13.63 AC.)
PROPOSED BUILDING:	
SCHOOL (3-STORY)	41,749 S.F.
MOSQUE	28,400 S.F.
MOSQUE ADDITION*	3,265 S.F.
MULTI-PURPOSE HALL	22,226 S.F.
GYMNASIUM:	25,595 S.F.
PARKING REQUIRED:	692 SPACES
PARKING PROVIDED:	780 SPACES (INCL. 19 HANDICAP STALLS)
BICYCLE PARKING REQUIRED:	43 STALLS
BICYCLE PARKING PROVIDED:	49 STALLS

* THE PHASE V MOSQUE AND PARKING EXPANSION WILL ONLY BE APPROVED SUBJECT TO APPROVAL OF A MAJOR CHANGE TO THE CONDITIONAL USE.

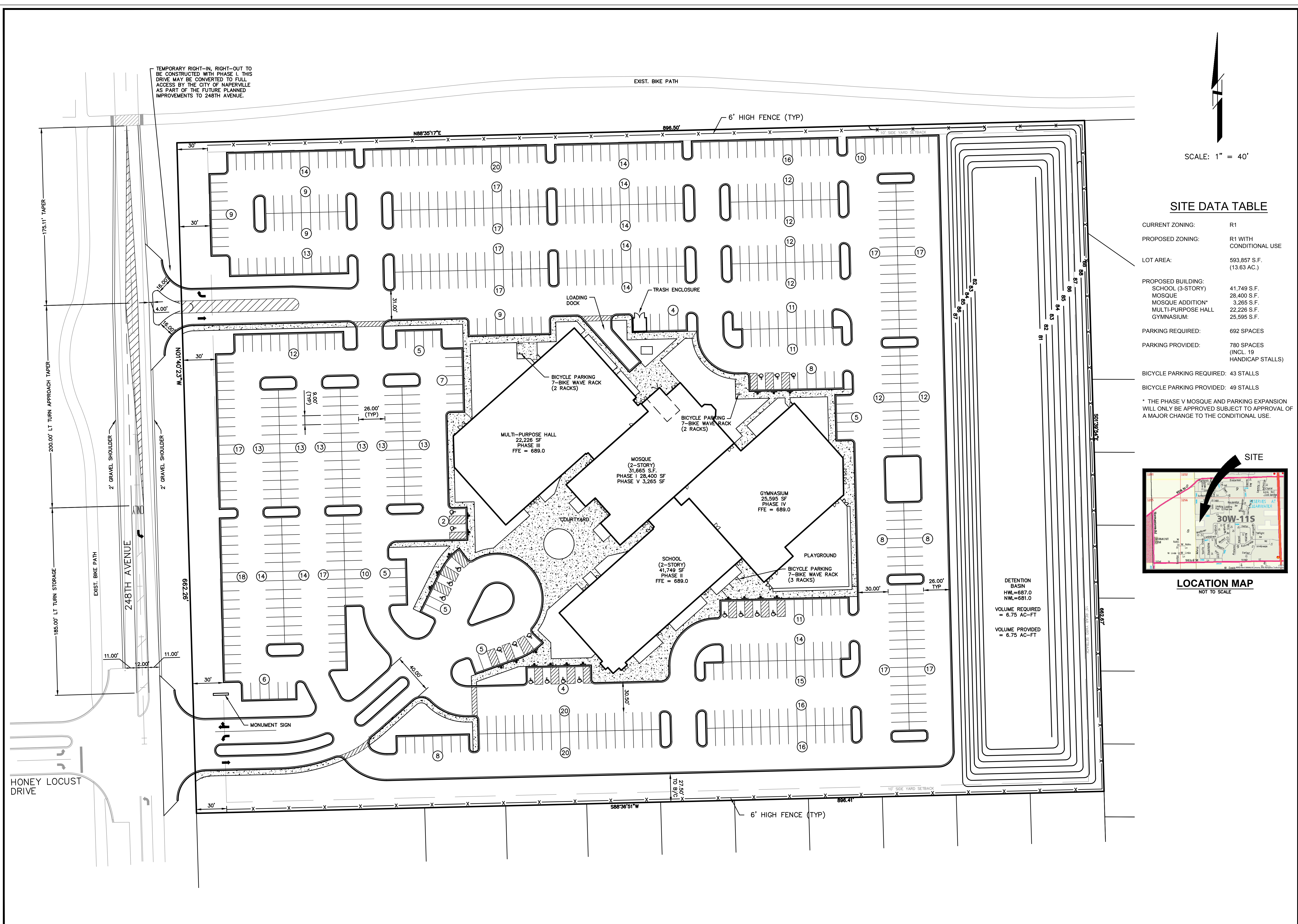
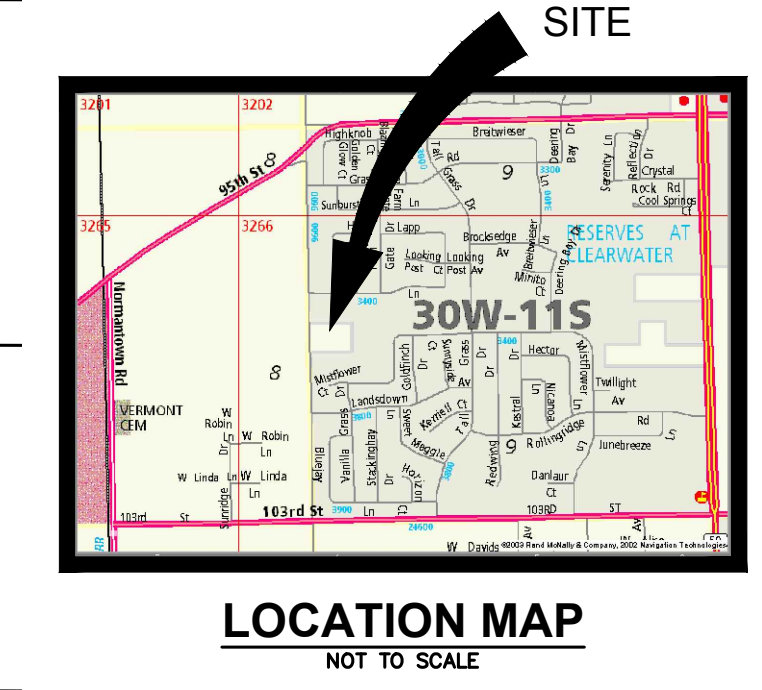

DATE: 10-26-21
BY: BC

REVISION: 10-15-21
DATE: 8-21-21
BY: BC

REVISION: 7-12-21
DATE: 8-27-20
BY: BC

REVISION: 4-27-20
DATE: 4-27-20
BY: BC

INTECH CONSULTANTS, INC.
1889 UNIVERSITY LANE, SUITE D
NAPERVILLE, ILLINOIS 60532
PHONE: 630-964-5656
ILLINOIS REGISTRATION NO. 184-007040

ISLAMIC CENTER OF NAPERVILLE
248TH AVENUE SITE
NAPERVILLE, ILLINOIS

MASTER SITE PLAN

SCALE: 1"=40'
DATE: 3-30-20
DRAWN: BC
DESIGNED: EFS
PROJECT NO: 2011-016B
SHEET 1 OF 1